

Schofields wastewater services

We are building new wastewater pipelines and infrastructure to service future development in Schofields, in the North West Growth Area.

About our work

We're delivering new wastewater services to cater for growth in parts of North West Sydney. This includes the [Schofields](#) precinct defined by the [Department of Planning and Environment](#).

The work includes:

- 300 metres of wastewater mains near Oak Street, Schofields and Guntawong Road, Riverstone (see [Figure 1](#))
- new wastewater pumping station south of Veron Road, Schofields located within the DHA development (see [Figure 2](#))
- 2.6 kilometres of new pressure and gravity wastewater mains connecting the new pumping station to the existing gravity main in near Pomeroy Street, Schofields (see [Figure 2](#))
- ventilation shafts about every 400 metres along the new wastewater mains
- maintenance holes about every 120 metres, or at changes of direction, along the new wastewater mains.

What we've done already

We completed a concept design for the new wastewater pumping station and wastewater mains, and displayed the proposed location and routes at community information sessions in December 2015.

We then engaged AAJV (a joint venture between Aurecon and AECOM) to prepare the detailed design.

What we will be doing next

Wastewater mains near Oak Street and Guntawong Road

We have engaged Veolia Water Technologies to construct the new wastewater mains near Oak Street and Guntawong Road, Schofields.

Construction of the wastewater mains started in March 2018 and will be finished in October 2018, weather permitting.

Work hours are 7 am to 6 pm Monday to Friday and 8 am to 1 pm Saturdays, if required.

To know more contact Veolia's Community Relations representative Brooke Taylor by:

- emailing Brooke.Taylor@veolia.com
- calling 1300 794 964

Wastewater pumping station and associated pressure and gravity mains

AAJV has completed the detailed design and engaged with key stakeholders and impacted landowners.

We are currently in the process of engaging contractors to do the work. Construction is due to be completed by early 2019.

Connecting to our pipeline

Sydney Water is in the process of building new trunk mains in growing areas of Sydney. Trunk mains are large water and wastewater pipelines that customers can't connect directly into.

Once the trunk mains have been built, developers or property owners will then need to build the next stage of pipelines, called lead-ins and/or reticulation pipelines. These are needed to service individual properties.

Direct connections to pressure mains is not possible.

If you'd like to connect to our wastewater system, you'll need to engage a [Water Servicing Coordinator](#).

A Water Servicing Coordinator can help you with your application to adjust, extend or connect into our pipes. Coordinators can answer questions about your application on our behalf and can also facilitate the project management, design and construction of any required work. They're not employed by Sydney Water.

If water and wastewater services are available to your property and you have a small to medium development or minor sewer works, you need to get a Section 73 Certificate. You have a choice of using a Water Servicing Coordinator or applying directly to us online through [Sydney Water Developer Direct™](#).

Figure 1 – Approximate location of new wastewater mains near Oak Street, Schofields and Guntawong Road, Riverstone

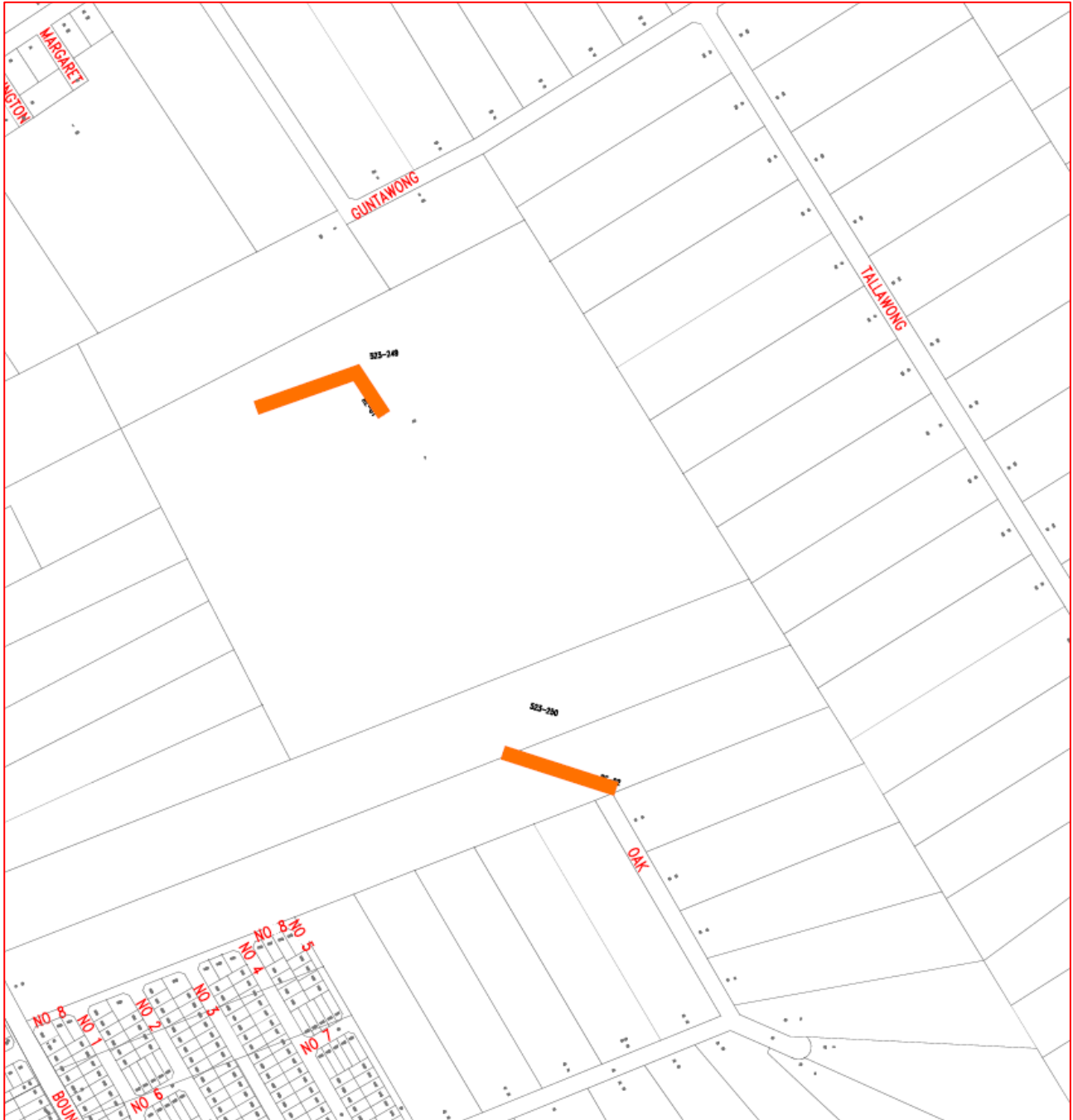

Legend



-  New Wastewater Main
-  Property Boundary

Figure 2 – Approximate location of new wastewater pumping station south of Veron Road, Schofields and associated wastewater mains

